

PROPERTY DETAILS

**CLASS E / SHOP / OFFICE
TO LET / FOR SALE**

Location:	DARTFORD / KENT
Property:	16 Hythe Street, DA1 1BX
Size:	1,126 Sq Ft (104.6 Sq M)



- Town Centre
- All Class E Uses available
- Central Heating
- Suspended Ceilings & Fitted Office

CHARTERED SURVEYORS
AND PROPERTY CONSULTANTS

The Granary
1 Waverley Lane
Surrey GU9 8BB
www.traynorryan.co.uk



Location

Dartford Town Centre

A2 – 3 miles

Dartford Rail Station - 3 miles

Description

The property comprises a mid-terrace Victorian building in retail use on ground and two upper floors.

Floor Areas

The property has been measured in accordance with RICS Property Measurement Standard s, 2nd edition:

	Sq M	Sq Ft
Ground	34.8	374
First	34.9	376
Second	34.9	376
	104.6	1126

Rent

Rental offers invited.

Price

Offers invited for the freehold interest.

Lease

A new lease is available on terms to be agreed. Sections 24-28 of the Landlord and Tenant Act are Excluded.

Business Rates

No business rates are payable by small businesses.

Viewing

Strictly by appointment through sole agents Contact Warren Traynor.

01252 794144

wt@traynorryan.co.uk

Costs

All legal costs to be borne by the ingoing tenant.



Floor Plans

16 Hythe Street, Dartford

Approximate Gross Internal Area
1367 sq ft - 127 sq m

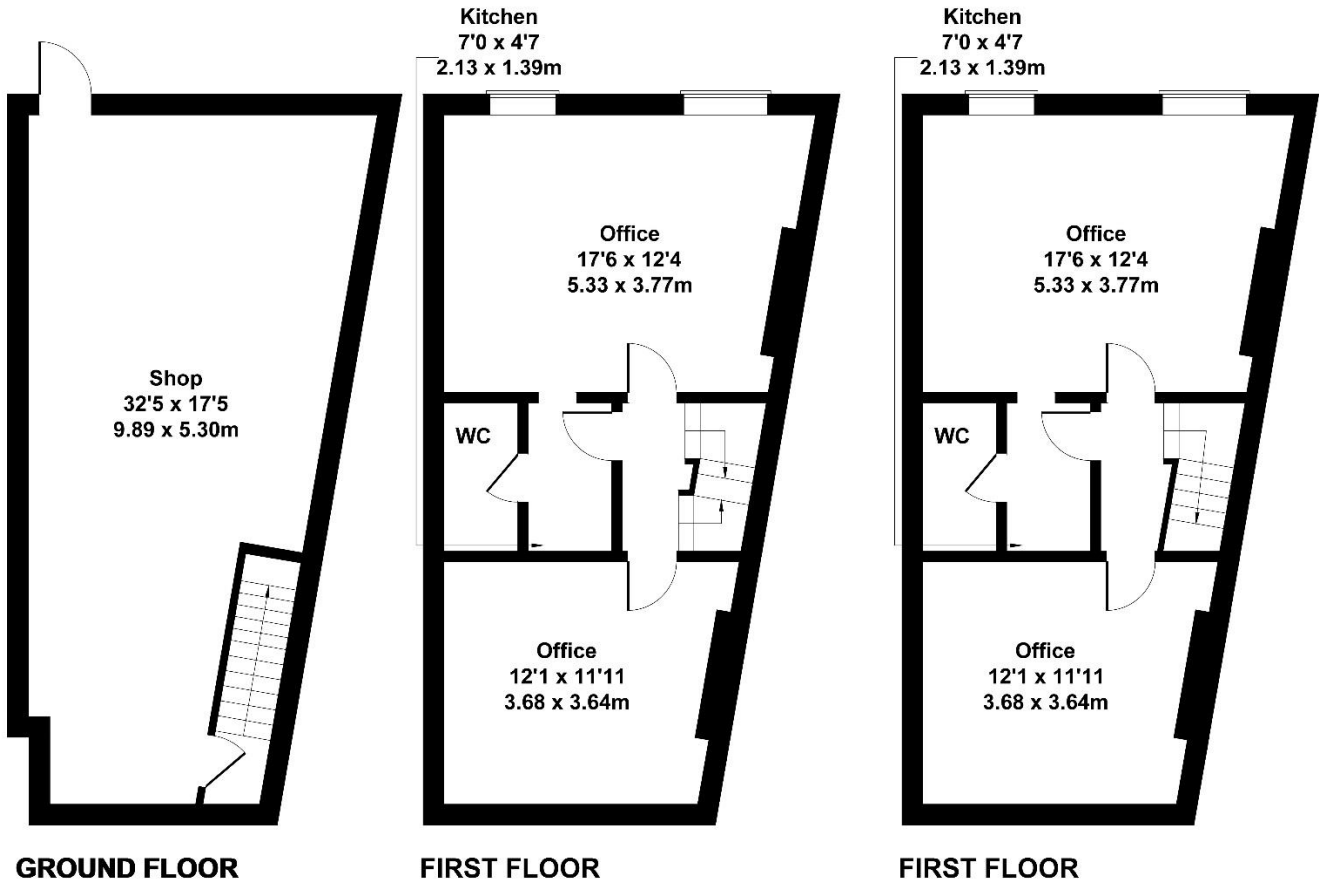

Not to Scale. Produced by The Plan Portal 2023
For Illustrative Purposes Only.